



Jordan fishwick

165 New Barns Avenue, Chorlton, M21 7DG

Guide Price £395,000



**165 New Barns Avenue,
Chorlton, Manchester,
M21 7DG**
Guide Price £395,000



The Property

*****COMPLETE CHAIN***** Located on a well regarded development only a short stroll from Chorlton Village is this superbly presented **THREE DOUBLE BEDROOM TOWNHOUSE** which is offered for sale in **MOVE-IN READY** condition having been tastefully updated throughout by the current owners. This splendid property will prove ideal for a couple or family with spacious and light accommodation over three floors as well as **OFF ROAD PARKING** and well stocked gardens to both the front and rear. The property further benefits from being located only a short walk from multiple local schools, parks and transport links including the Metrolink. The accommodation briefly comprises: covered porch, entrance hallway, 16ft lounge/dining room, modern shaker style fitted kitchen with subway tile splash back, cloakroom / wc. To the first floor there are two good sized double bedrooms and main bathroom fitted with a modern three piece suite, electric **UNDERFLOOR HEATING** and striking feature tiling while the second floor reveals the principle suite comprising of a well proportioned double bedroom with **EN-SUITE** shower room, also fitted with a modern three piece suite, feature tiling and electric underfloor heating. Both double glazing and gas central heating have been installed throughout. Externally, to the front of the property is a lawned garden and path leading to the front door while to the side is a driveway providing off road parking. To the rear a fenced and enclosed garden features an Indian sandstone patio and well stocked beds. An internal viewing is most highly recommended. Sold with a complete chain - the vendors have had an offer accepted on a property that is sold with no onward chain.

- Superbly presented modern townhouse
- Three double bedrooms, two bathrooms + w/c
- Recently refitted kitchen and bathrooms
- Quiet and well regarded residential development
- Walking distance from Chorlton Village
- Well placed for multiple local schools and parks
- Driveway providing off road parking
- Move-in ready condition
- Ideal for a couple or family
- Council Tax: D



| Energy Efficiency Rating | | |
|---|----------------------------|-----------|
| | Current | Potential |
| Very energy efficient - lower running costs | | |
| (92 plus) A | | |
| (81-91) B | | |
| (69-80) C | | |
| (55-68) D | | |
| (39-54) E | | |
| (21-38) F | | |
| (1-20) G | | |
| Not energy efficient - higher running costs | | |
| England & Wales | EU Directive 2002/91/EC | |



GROUND FLOOR
385 sq.ft. (35.8 sq.m.) approx.

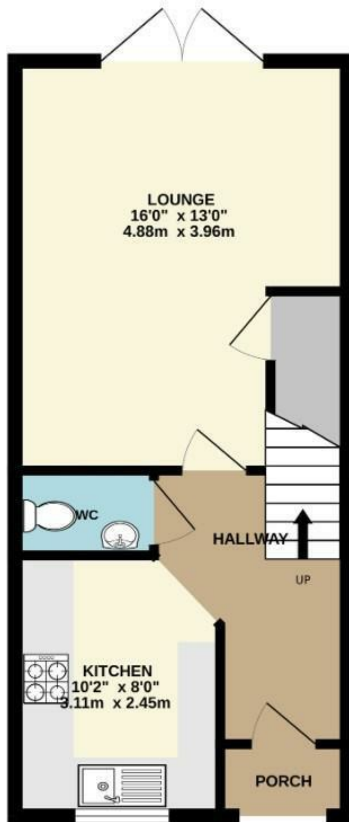

1ST FLOOR
360 sq.ft. (33.4 sq.m.) approx.

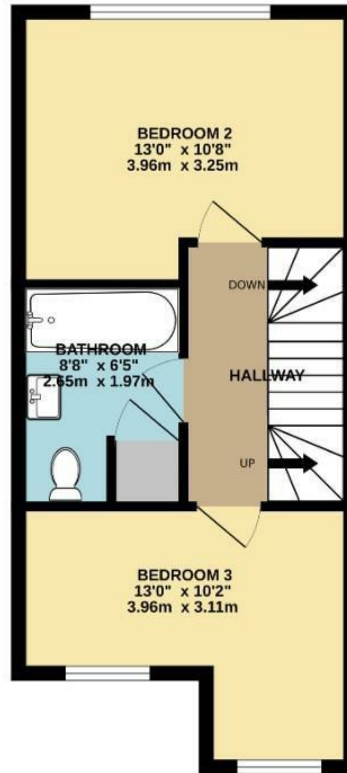

2ND FLOOR
330 sq.ft. (30.7 sq.m.) approx.

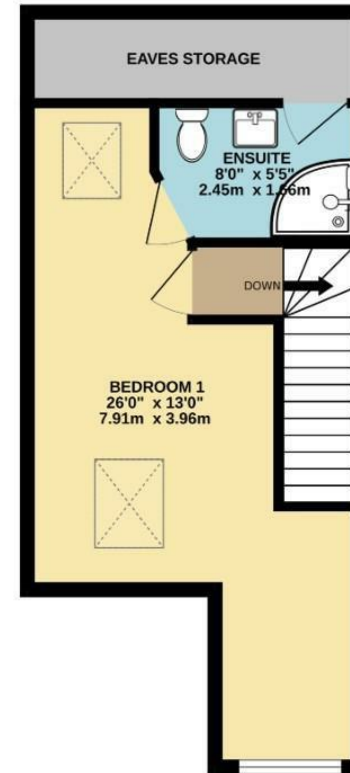

TOTAL FLOOR AREA : 1075 sq.ft. (99.9 sq.m.) approx.
Measurements are approximate. Not to scale. Illustrative purposes only
Made with Metropix ©2025



These particulars are believed to be accurate but they are not guaranteed and do not form a contract. Neither Jordan Fishwick nor the vendor or lessor accept any responsibility in respect of these particulars, which are not intended to be statements or representations of fact and any intending purchaser or lessee must satisfy himself by inspection or otherwise as to the correctness of each of the statements contained in these particulars. Any floorplans on this brochure are for illustrative purposes only and are not necessarily to scale.

Offices at: Chorlton, Didsbury, Disley, Hale, Glossop, Macclesfield, Manchester Deansgate, Manchester Whitworth Street, New Mills, Sale, Wilmslow and Withington